



City of Alameda, California

July 18, 2018

TO: PROSPECTIVE BIDDERS

CYCLIC SEWER REPLACEMENT PROJECT, PHASE 15
No. P.W. 03-18-10
ADDENDUM NO. 1

Addendum No. 1 is hereby issued to make the following revision to the plans and specifications:

1. Plans
 - a. Sheets 20, 21, 22: Please replace with attached plans.
2. Specifications
 - a. Section IX. Quantities: Please replace Section IX. Quantities with attached.
 - b. Exhibit "A", Section XIV. Bidder's Proposal Form: Please replace Exhibit "A" with attached Exhibit "A". Contractor shall use attached updated version for submittal of bid.

APPROVED: 
Scott Wikstrom
City Engineer

7/18/18
Date

Receipt is hereby acknowledged of Addendum No. 1, CYCLIC SEWER REPLACEMENT PROJECT, PHASE 15 - No. P.W. 03-18-10.

Company Name / Contractor

Date: _____

By: _____

NOTE: THIS COMPLETE ADDENDUM, SIGNED AND DATED MUST BE RETURNED WITH YOUR BID.

cc: City Clerk

G:\PUBWORKS\FORMS\PWADMIN\ADD.WPD

Public Works Department
950 W. Mall Square, Room 110
Alameda, California 94501
510 747-7900 Fax 510-769-6030 TTY 510-522-7338

Printed on 30% PCW Paper

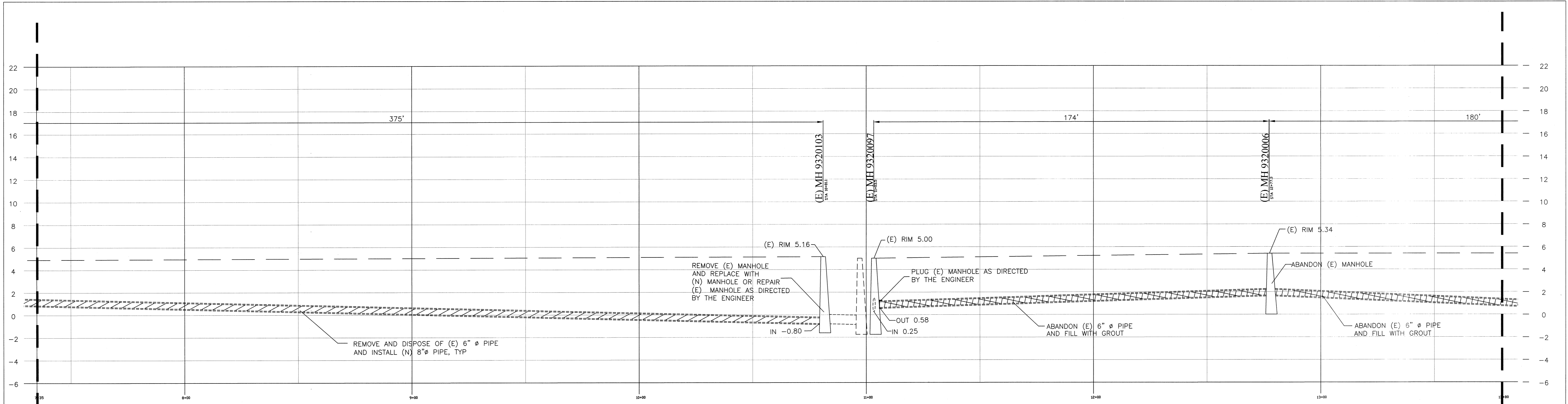

1 PROFILE - EAGLE AVENUE
 SCALE: HORIZONTAL: 1"=20'-0"
 VERTICAL 1"=4'-0"

MATCH LINE STA 7+35 - SEE SHEET 19

MATCH LINE STA 13+80 - SEE SHEET 21

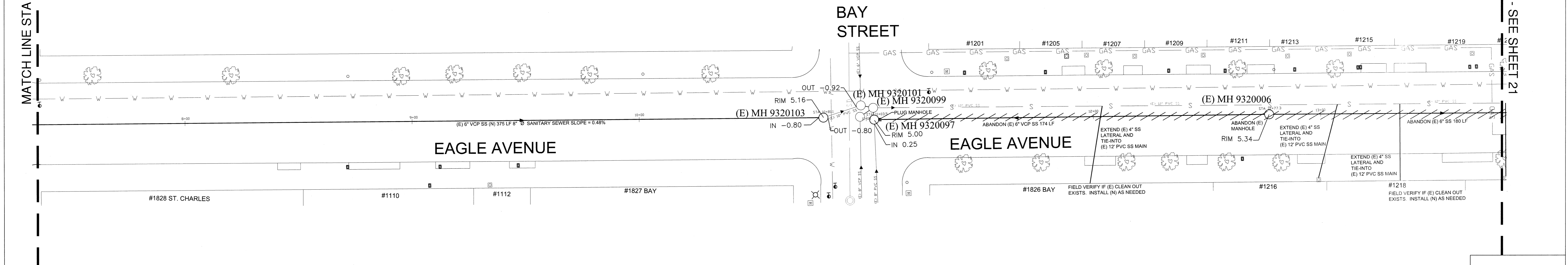

2 PLAN - EAGLE AVENUE
 SCALE: 1"=20'-0"

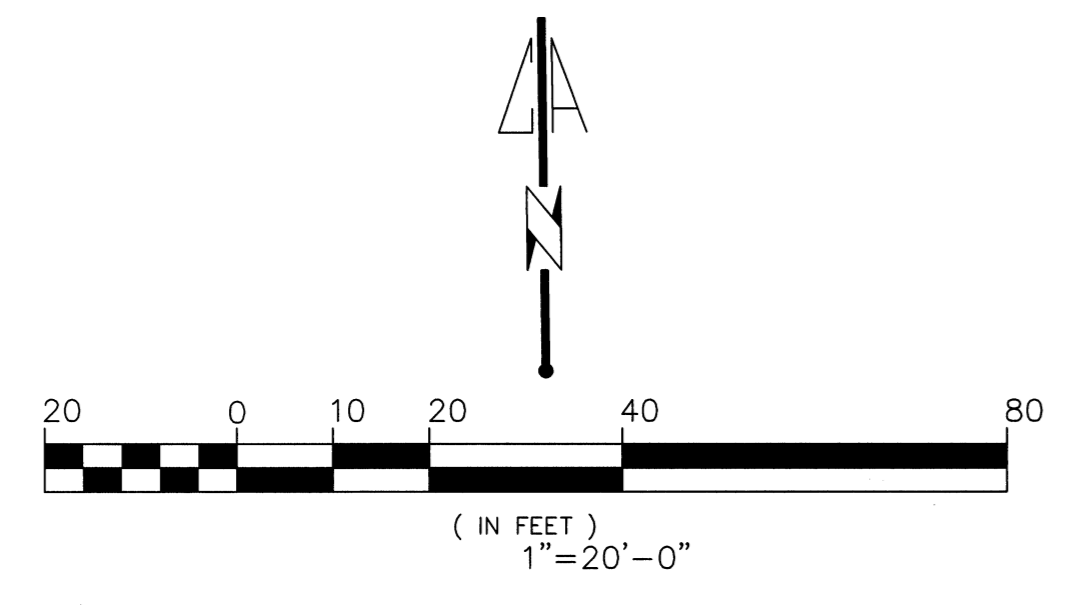

EAGLE AVENUE AT BAY STREET

REFERENCE				CITY OF ALAMEDA CALIFORNIA ENGINEERING DEPARTMENT	
NO.	REVISED	BY	APP.	APPROVED BY CITY ENGINEER DATE 7/10/18 CYCLIC SEWER REPLACEMENT PROJECT, PHASE 15	
DESIGNED	PHILIP LEE				
DRAWN	PHILIP LEE				
CHECKED	PLAVIO BARRANTES				
DATE	MAY 2018	SCALE	1"=20'	SHEET	20 OF 39
				DWG.	CASE
				9412	35

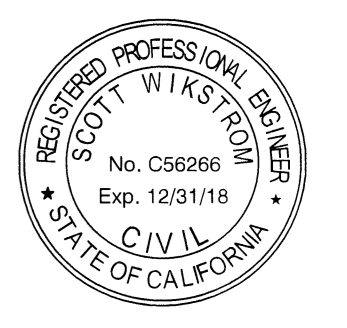

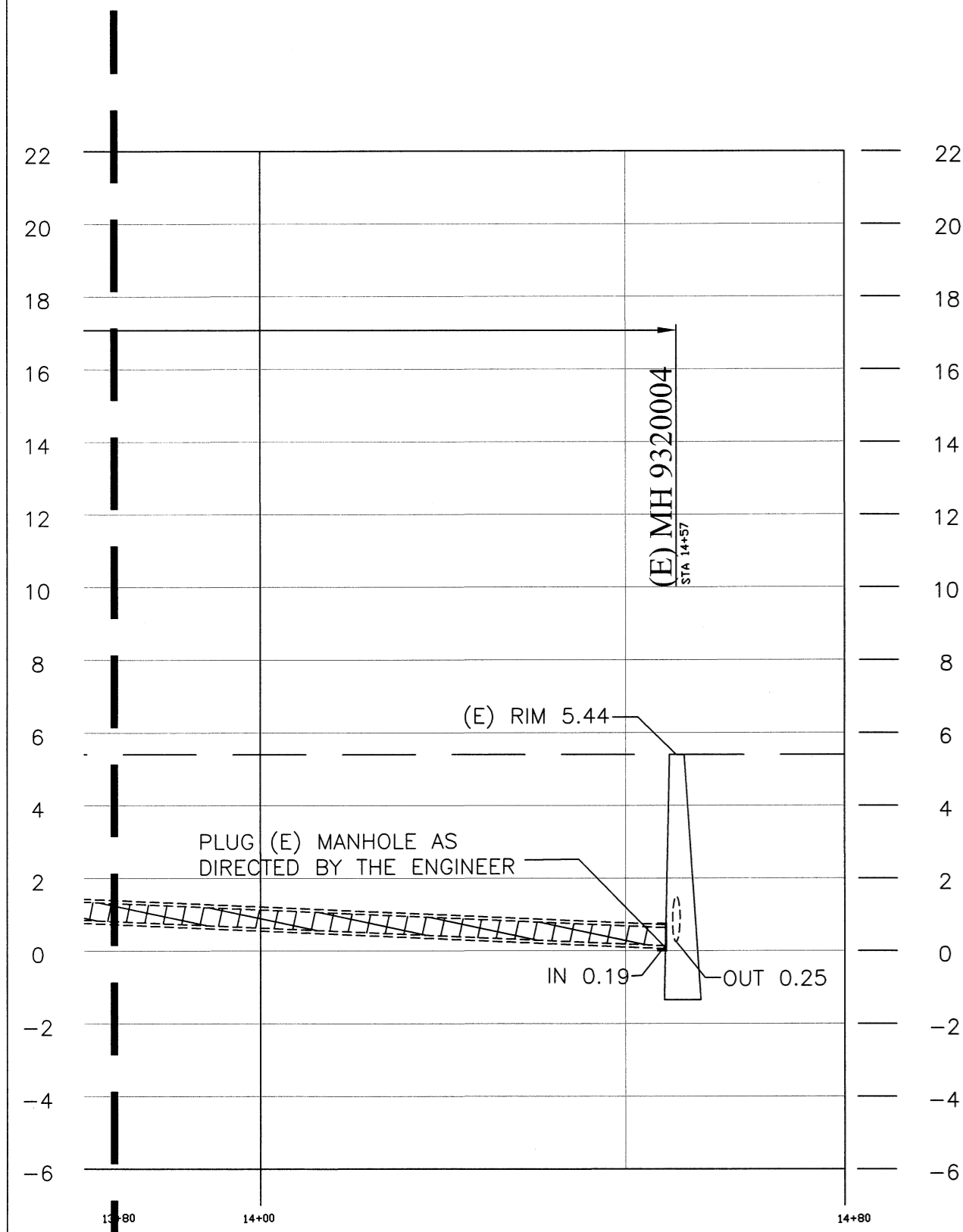

1 PROFILE - EAGLE AVENUE
 21 SCALE: HORIZONTAL: 1"=20'-0"
 VERTICAL 1"=4'-0"

MATCH LINE STA 13+80 - SEE SHEET 20

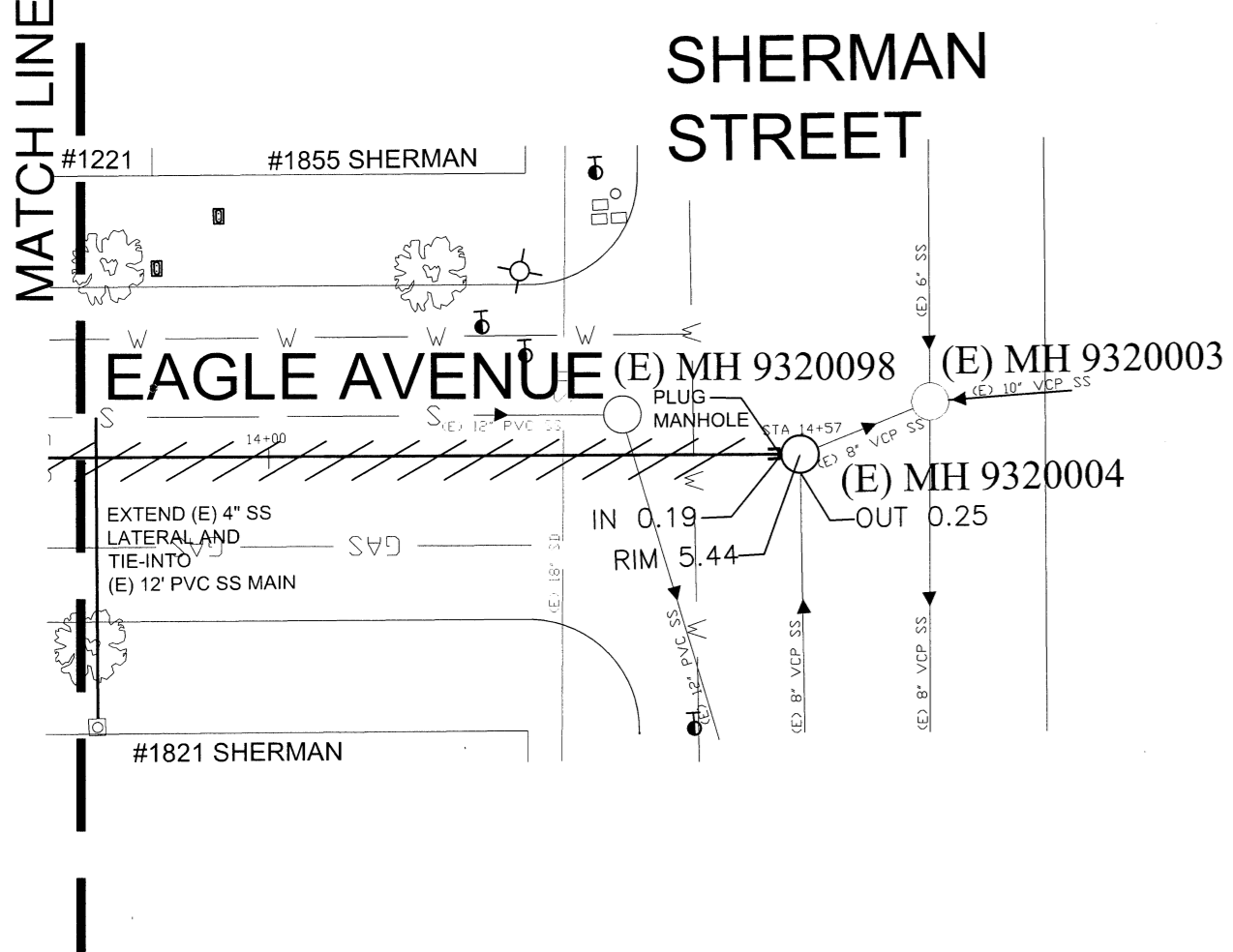

2 PLAN - EAGLE AVENUE
 21 SCALE: 1"=20'-0"

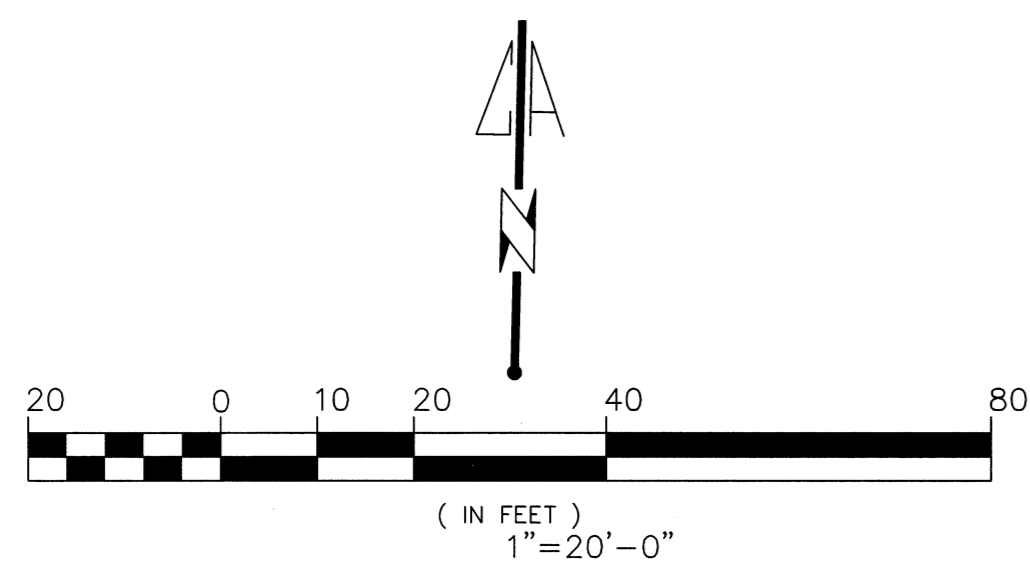

EAGLE AVENUE AT SHERMAN STREET

REFERENCE				CITY OF ALAMEDA CALIFORNIA ENGINEERING DEPARTMENT		APPROVED BY <i>[Signature]</i> CITY ENGINEER	
				CYCLIC SEWER REPLACEMENT		DATE 7/12/18	
				PROJECT, PHASE 15		SHEET 21 OF 39	
				DESIGNED PHILIP LEE		DWC. CASE	
				DRAWN PHILIP LEE		9412 35	
				CHECKED FLAVIO BARBANTES			
				DATE MAY 2018		SCALE 1"=20'	



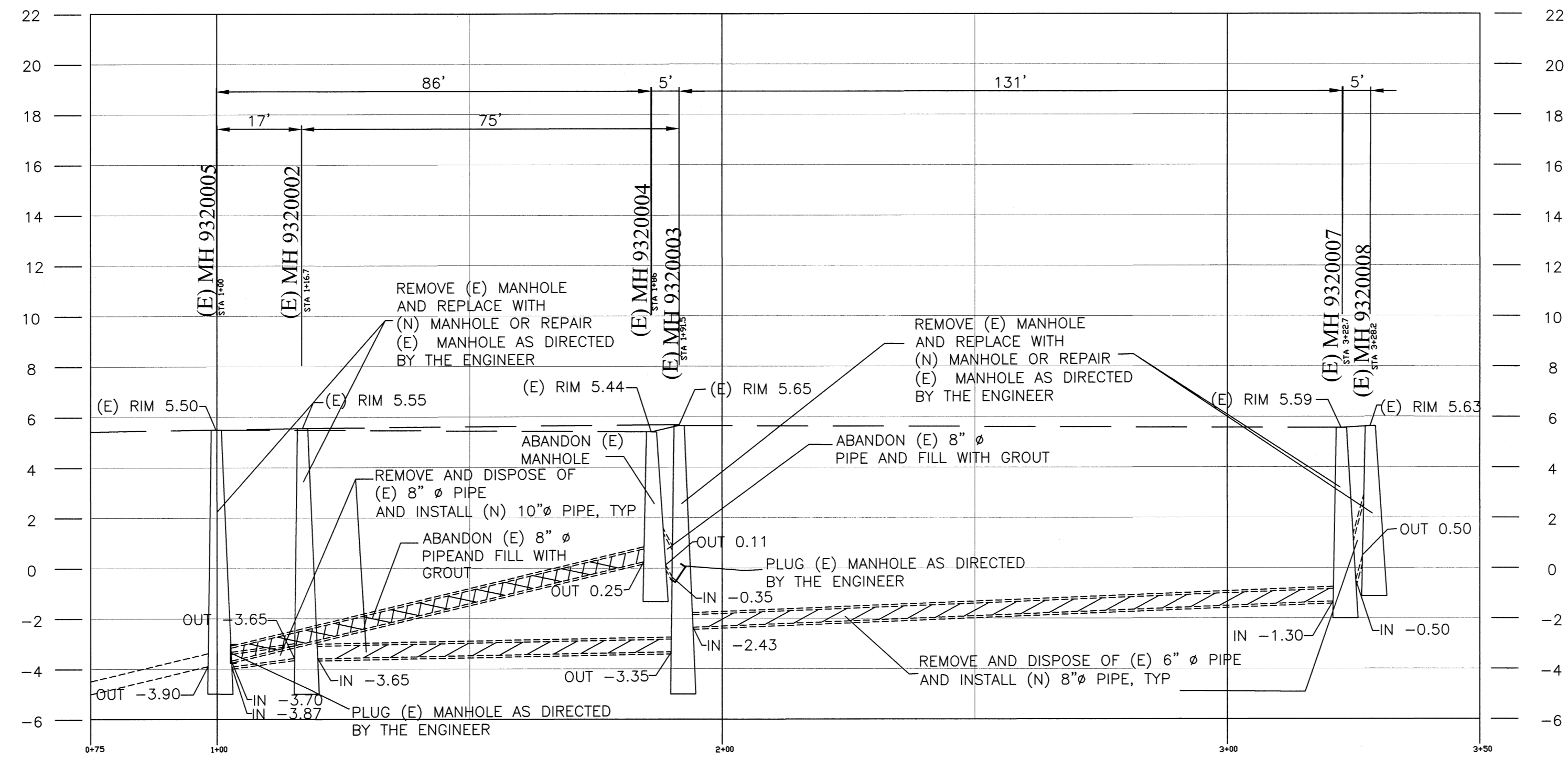

1 PROFILE - SHERMAN STREET
 22 SCALE: HORIZONTAL: 1"=20'-0"
 VERTICAL 1"=4'-0"

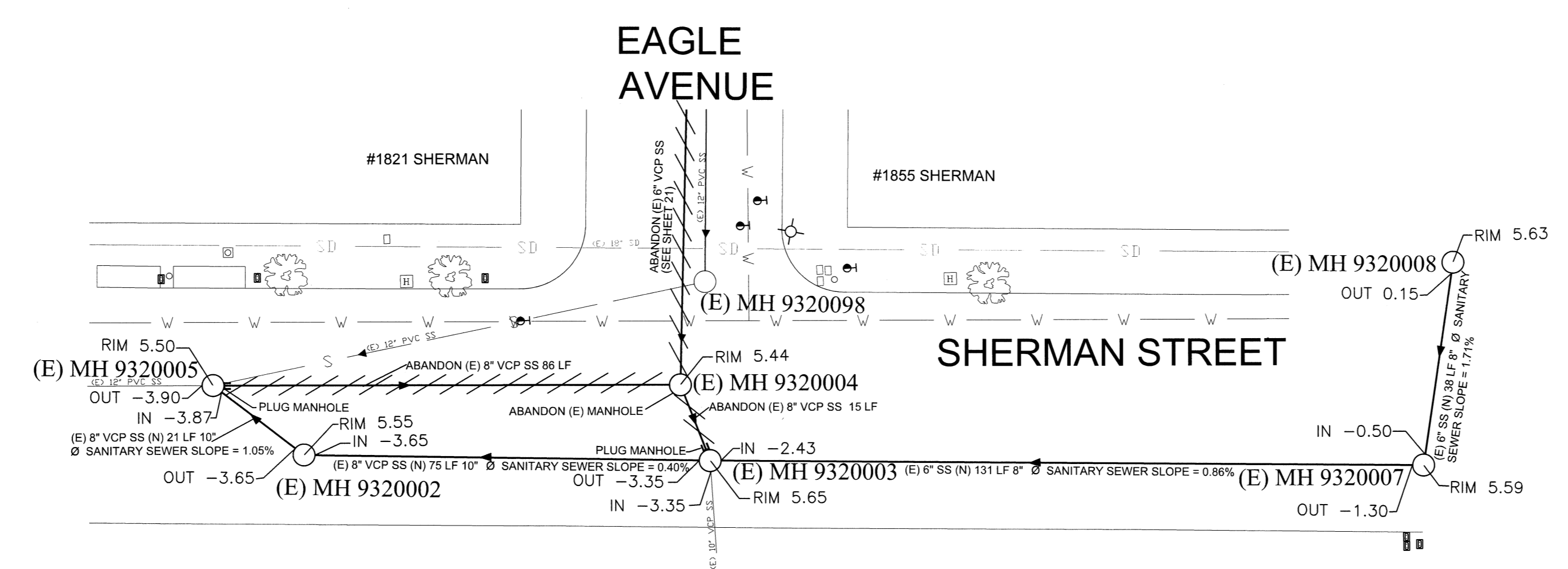

2 PLAN - SHERMAN STREET
 22 SCALE: 1"=20'-0"

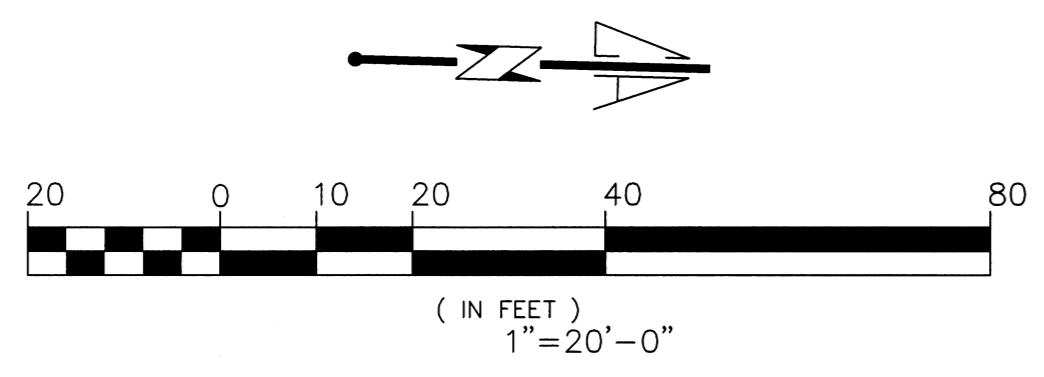

SHERMAN STREET AT EAGLE AVENUE

REFERENCE			
NO.	REVISED	BY	APP.

CITY OF ALAMEDA
 CALIFORNIA
 ENGINEERING DEPARTMENT

CYCLIC SEWER REPLACEMENT
 PROJECT, PHASE 15



APPROVED BY: *[Signature]*
 CITY ENGINEER

DATE: 7/18/18

SHEET 22 OF 39

DWG: 9412 CASE: 35

SECTION IX. QUANTITIES

The following preliminary estimate of the quantities of work to be done and materials to be furnished is approximate only, and the City of Alameda does not expressly or by implication agree that the actual amount of work will correspond therewith, but reserves the right to increase or decrease the amount of any class or portion of the work or to omit portions of the work that may be deemed necessary or expedient to the Engineer.

Quantities shall be determined by the Contractor from plans and specifications, and /or pre-construction meeting and walk - through. Any discrepancy or conflict shall be reported to the Project Manager. Contractor shall be held responsible for any discrepancies or conflicts not reported to the Project Manager seventy-two (72) hours prior to the bid opening.

The basis of award of contract shall be by the City of Alameda for the lowest and best bid that will best serve the City's need. The contract shall be awarded with the entire project based bid.

The City reserves the right to reject any, any portion, or all bids.

The base bid consists of twenty-seven (27) bid items, as outlined below and detailed in Section XII, L, Extent of Contract.

TABULATION OF PRELIMINARY ESTIMATE OF QUANTITIES

Item No.	Description	Quantity	Unit
1.	Mobilization	1	Lump sum
2.	Maintaining Traffic	1	Lump sum
3.	Replacing Existing SS Main with 8" Pipe (Open Trench)	12,749	Linear Foot
4.	Replacing Existing SS Main with 8" Pipe (Pipe Burst)	1,050	Linear Foot
5.	Replacing Existing SS Main with 6" Pipe (Pipe Burst)	166	Linear Foot
6.	Replace Existing SS Main with 10" Pipe (Open Trench)	611	Linear Foot
7.	Replace Existing SS Lateral with 4" Pipe (Open Trench)	100	Linear Foot

TABULATION OF PRELIMINARY ESTIMATE OF QUANTITIES continued

Item No.	Description	Quantity	Unit
8.	Replace Existing SS Lateral with 4" Pipe (Pipe Burst)	14,350	Linear Foot
9.	Replace Existing SS Lateral with 6" Pipe (Pipe Burst)	60	Linear Foot
10.	Install 4" 2-Way Kelly Cleanout	199	Each
11.	Install 6" 2-Way Kelly Cleanout	2	Each
12.	Remove Existing MH and Construct New MH	60	Each
13.	Install New Manhole	8	Each
14.	Rehabilitate Manhole	26	Each
15.	Replace Manhole Lid and Casting	43	Each
16.	Reconstruct Sidewalk	6,000	Square Foot
17.	Reconstruct Curb and Gutter	1,000	Linear Foot
18.	Asphalt Concrete Patch	1,000	Ton
19.	Asphalt Concrete Bridge	1,000	Ton
20.	Mechanical Sheeting and Shoring of Sewer Trench	15,000	Linear Foot
21.	Signage and Striping Restoration	1	Lump Sum
22.	Permits	1	Allowance
23.	Stockpiling of Contaminated Soil	20	Ton
24.	Import Borrow	20	Ton
25.	Contaminated Water	1,000	Gallon
26.	Abandon Existing Manhole	2	Each
27.	Abandon Existing Sewer Line & Fill with Grout	455	Linear Foot

Exhibit 'A'

BIDDER'S PROPOSAL FORM

Bidder's Proposal

Subcontractors to be used in the Performance of this Contract (Form)

Executed Agreement to be Bound to PSA

Security For Compensation Certificate

Important Instructions

SECTION XIV. BIDDER'S PROPOSAL

Specifications and Special Provisions

Proposal to the COUNCIL of the CITY OF ALAMEDA:

No. P.W. 03-18-10

The undersigned declares that he has carefully examined the location of the proposed work and the Plans, Specifications, and Special Provisions therefore, referred to herein, and hereby proposes to furnish all labor, materials, machinery, tools and equipment required to perform the work, and to do all the said work, in accordance with said Plans, Specifications and Special Provisions for the unit prices set forth in the following schedule:

Filed:

Cyclic Sewer Replacement Project,
Phase 15
Alameda, California

Item No.	Approximate Quantity	Items with Unit Prices Written in Words	Unit Price	Total Price
1.	1 Lump Sum	Mobilization		
		@ _____	\$ _____	\$ _____

		Lump Sum		
2.	1 Lump Sum	Maintaining Traffic		
		@ _____	\$ _____	\$ _____

		Lump Sum		

Item No.	Approximate Quantity	Items with Unit Prices Written in Words	Unit Price	Total Price
3.	12,749 LF	Replacing Existing SS Main with 8" Pipe (Open Trench)		
		@ _____	\$ _____	\$ _____

		Linear Foot		
4.	1,050 LF	Replacing Existing SS Main with 8" Pipe (Pipe Burst)		
		@ _____	\$ _____	\$ _____

		Linear Foot		
5.	166 LF	Replacing Existing SS Main with 6" Pipe (Pipe Burst)		
		@ _____	\$ _____	\$ _____

		Linear Foot		
6	611 LF	Replacing Existing SS Main with 10" Pipe (Open Trench)		
		@ _____	\$ _____	\$ _____

		Linear Foot		

Item No.	Approximate Quantity	Items with Unit Prices Written in Words	Unit Price	Total Price
7.	100 LF	Replacing Existing SS Lateral with 4" Pipe (Open Trench)		
		@ _____	\$ _____	\$ _____

		Linear Foot		
8.	14,350 LF	Replacing Existing SS Lateral with 4" Pipe (Pipe Burst)		
		@ _____	\$ _____	\$ _____

		Linear Foot		
9.	60 LF	Replacing Existing SS Lateral with 6" Pipe (Pipe Burst)		
		@ _____	\$ _____	\$ _____

		Linear Foot		
10.	199 EA	Install 4" 2-Way Kelly Cleanout		
		@ _____	\$ _____	\$ _____

		Each		
11.	2 EA	Install 6" 2-Way Kelly Cleanout		
		@ _____	\$ _____	\$ _____

		Each		

Item No.	Approximate Quantity	Items with Unit Prices Written in Words	Unit Price	Total Price
12.	60 EA	Remove Existing Manhole and Construct New Manhole @ _____ _____ Each	\$ _____	\$ _____
13.	8 EA	Install New Manhole @ _____ _____ Each	\$ _____	\$ _____
14.	26 EA	Rehabilitate Manhole @ _____ _____ Each	\$ _____	\$ _____
15.	43 EA	Replace Manhole Lid and Casting @ _____ _____ Each	\$ _____	\$ _____
16.	6,000 SF	Reconstruct Sidewalk @ _____ _____ Square Foot	\$ _____	\$ _____

Item No.	Approximate Quantity	Items with Unit Prices Written in Words	Unit Price	Total Price
17.	1,000 LF	Reconstruct Curb and Gutter		
		@ _____	\$ _____	\$ _____

		Linear Foot		
18.	1,000 Ton	Asphalt Concrete Patch		
		@ _____	\$ _____	\$ _____

		Ton		
19.	1,000 Ton	Asphalt Concrete Bridge		
		@ _____	\$ _____	\$ _____

		Ton		
20.	15,000 LF	Mechanical Sheeting and Shoring of Sewer Trench		
		@ _____	\$ _____	\$ _____

		Linear Foot		
21.	1 Lump Sum	Signage and Striping Restoration		
		@ _____	\$ _____	\$ _____

		Lump Sum		

Item No.	Approximate Quantity	Items with Unit Prices Written in Words	Unit Price	Total Price
22.	1 Allowance	Permits @ <u>Five Thousand Dollars</u> _____ Allowance	\$ <u>5,000.00</u>	\$ <u>5,000.00</u>
23.	20 Ton	Stockpiling of Contaminated Soil @ _____ _____ Ton	\$ _____	\$ _____
24.	20 Ton	Import Borrow @ _____ _____ Ton	\$ _____	\$ _____
25.	1,000 Gallon	Contaminated Water @ _____ _____ Gallon	\$ _____	\$ _____
26.	2 EA	Abandon Existing Manhole @ _____ _____ Each	\$ _____	\$ _____

Item No.	Approximate Quantity	Items with Unit Prices Written in Words	Unit Price	Total Price
27.	455 LF	Abandon Existing Sewer Line & Fill with Grout		
		@ _____	\$ _____	\$ _____

		Linear Foot		

TOTAL BID \$ _____

Amount of Time Required to Commence
 Work After Receipt of Work Order: 10 Days

The undersigned agrees to execute the contract required in said Specifications, to the satisfaction of the Council of the City of Alameda, with the necessary bonds, if any be required, within ten days, not including Sundays or legal holidays, after receiving notice that the contract has been awarded and is ready for signature; and further agrees that, in case of his default in any of the foregoing provisions, the proceeds of any check which may accompany his bid in lieu of a bid bond shall become the property of the City of Alameda as agreed and liquidated damages.

Firm Name (Please Print) _____

Signature of Person on Behalf of Firm _____

Business Address _____

Dated: _____

Zip Code _____

Name	Title	Address
(Of Officers or Partners)		

Incorporated under the laws of the State of _____

Contractor's License No. _____ Expiration Date: _____

Department of Industrial Relations (DIR) No.: _____

The signature above certifies that the foregoing information given on this document is true and correct under penalty of perjury. (Section 7028.15 California Business and Professionals Code.)

PROPOSED SUBCONTRACTOR FORM

The Bidder shall list the name, address, license number and Department of Industrial Relations number of each subcontractor to whom the Bidder proposes to subcontract portions of the work, as required by the provisions in Section 2-1.054, "Required Listing of Proposed Subcontractors," of the Standard Specifications and Section 2-1.01, "General," for the special provisions.

COMPANY NAME	CA LICENSE NO.	BUSINESS ADDRESS	DESCRIPTION OF WORK	DIR NO.

(This form may be duplicated if necessary to list additional subcontractors)

The bidder's execution on the signature portion of this proposal shall also constitute an endorsement and execution of those certifications which are a part of this proposal)

EQUAL EMPLOYMENT OPPORTUNITY CERTIFICATION

The bidder _____, proposed subcontractor, hereby certified that he has ____, has not ____, participated in a previous contract or subcontract subject to the equal opportunity clauses, as required by Executive Orders 10925, 11114, or 11246, and that, where required, he has filed with the Joint Reporting Committee, the Director of the Office of Federal Contract Compliance, a Federal Government contracting or administering agency, or the former President's Committee on Equal Employment Opportunity, all report due under the applicable filing requirements.

NOTE: The above certification is required by the Equal Employment Opportunity Regulations of the Secretary of Labor (41 CFR 60-1.7(b)(1)), and must be submitted by bidders and proposed subcontractors only in connection with contracts and subcontracts which are subject to the equal opportunity clause. Contracts and subcontracts which are exempt from the equal opportunity clause are set forth in 41 CFR 60-1.5. (Generally only contracts or subcontracts of \$10,000 or under are exempt.)

Currently, Standard Form 100 (EEO-1) is the only report required by the Executive Orders or their implementing regulations.

Proposed prime contractors and subcontractors who have participated in a previous contract or subcontract subject to the Executive Orders and have not filed the required reports should note that 41 CFR 60-1.7(b)(1) prevents the award of contracts and subcontracts unless such contractor submits a report covering the delinquent period or such other period specified by the Federal Highway Administration or by the Director, Office of Federal Contract Compliance, U.S. Department of Labor.

AGREEMENT TO BE BOUND TO PSA

**PROJECT STABILIZATION AGREEMENT FOR THE CITY OF
ALAMEDA AGREEMENT TO BE BOUND**

The undersigned party confirms that it agrees and assents to comply with and to be bound by the City of Alameda

Project Stabilization Agreement as such Agreement may, from time to time, be amended by the parties or interpreted pursuant to its terms.

By executing this Agreement To Be Bound, the undersigned party subscribes to, adopts and agrees to be bound by the written terms of the legally established trust agreements, as set forth in section 17, specifying the detailed basis upon which contributions are to be made into, and benefits made out of, such Trust Fund(s) and ratifies and accepts the trustees appointed by the parties to such Trust Fund(s) and agrees to execute a separate Subscription Agreement(s) for Trust Funds when such Trust Fund(s) require(s) such document(s).

Such assent and obligation to comply with and to be bound by this Agreement shall extend to all work covered by said Agreement undertaken by the undersigned party. The undersigned party shall require all of its subcontractors, of whatever tier, to become similarly bound for all their work within the scope of this Agreement by signing an identical Agreement To Be Bound.

This letter shall constitute a subscription agreement, to the extent of the terms of the letter.

Dated: _____

Project: _____

Signature of Authorized Officer

Authorized Officer & Title

Name of Contractor/Employer(s)

Contractor/Employer(s) Address

CSLB #

Area Code Phone

E-mail and/or Fax

Motor Carrier (CA) Permit Number

DIR Prevailing Wage Registration #

SECURITY FOR COMPENSATION CERTIFICATE

(Required by Paragraph 1861, California Labor Code)

To: _____

I am aware of the provisions of Section 3700 of the Labor Code of the State of California which requires every employer to be insured against liability for worker's compensation or to undertake self-insurance in accordance with the provisions of that Code, and I will comply with such provisions before commencing the performance of the work of this contract.

(Signature of Bidder)

Business Address

IMPORTANT INSTRUCTIONS

1. Any erasure or interlineation may invalidate bid.
2. If corporation is bidder, affix seal of corporation.
3. If bidder is:
 - (a) An individual doing business under his own name, sign his own name only.
 - (b) An individual using a firm name, sign: Example, "John Doe, an individual doing business as Blank Company."
 - (c) A co-partnership, sign: Example, "Blank Company, by John Doe, President" (or other title).
4. If a firm or co-partnership, give the names of all individual co-partners composing the firm. If a corporation, state legal name of corporation; also name of president, secretary and treasurer thereof.
5. If a bid is sent by mail, write the word "Proposal" plainly on the envelope.

Exhibit 'B'

**CERTIFIED PAYROLL AND
PREVAILING WAGES FORMS**

Contractor's Certification Concerning Labor Standards and Prevailing Wage Requirements

Subcontractor's Certification Concerning Labor Standards and Prevailing Wage Requirements

Certification of Bidder Regarding Section 3 and Segregated Facilities

Certification of Proposed Subcontractor Regarding Section 3 and Segregated Facilities

Certification of Understanding and Authorization

Certification For Applicable Fringe Benefit Payments

Authorization For Deductions

Employee Questionnaire

EXHIBIT B: Certified Payroll Forms

CITY OF ALAMEDA PUBLIC WORKS DEPARTMENT CONTRACTOR'S CERTIFICATION CONCERNING LABOR STANDARDS AND PREVAILING WAGE REQUIREMENTS		
(Appropriate Recipient):	DATE	
c/o	PROJECT NUMBER (if any)	
	PROJECT NAME	
1. The undersigned, having executed a contract with _____ _____ for the construction of the above-identified project acknowledges that:		
(a) The Labor Standards provisions are included in the aforesaid contract;		
(b) Correction of any infractions of the aforesaid conditions, including infractions any of his subcontractors and Any lower tier subcontractor, is his responsibility.		
2. He certifies that:		
(a) Neither he nor any firm, partnership or association in which he has substantial interest is designated as an ineligible contractor by the Comptroller General of the United States pursuant to Section 5.6(b) of the Regulations of the Secretary Labor, part 5 (29 CFR, Part 5) or pursuant to Section 3(a) of the Davis-Bacon Act as amended (40 U.S.C. 276u-2(a)).		
(b) No part of the aforementioned contract has been or will be subcontracted to any subcontractor if such subcontractor or any firm, corporation, partnership or association in which such subcontractor has a substantial interest is designated an ineligible contractor pursuant to any of the aforementioned regulatory or statutory provisions.		
He agrees to obtain and forward to the aforementioned recipient within ten days after the execution of any subcontract, including those executed by his subcontractors and any lower tier subcontractors, a Subcontractor's Certification Concerning Labor Standards at Prevailing Wage Requirements executed by the subcontractors.		
He certified that:		
(a) The legal name and the business address of the undersigned are:		
(b) The undersigned is:		
(1) A SINGLE PROPRIETORSHIP	(3) A CORPORATION ORGANIZED IN THE STATE OF	
(2) A PARTNERSHIP	(4) OTHER ORGANIZATION (Describe)	
(c) The name, title and address of the owner, partners or officers of the undersigned are:		
NAME	TITLE	ADDRESS

EXHIBIT B: Certified Payroll Forms

(d) The names and address of all other persons, both natural and corporate, having a substantial interest in the undersigned, and the nature of the interest are (if none, so state):		
NAME	TITLE	ADDRESS
(e) The names, address and trade classification of all other building construction contractors in which the undersigned, has a substantial interest are (if none, so state):		
NAME	TITLE	ADDRESS

3. He certifies:
(a) The company's Federal Tax Identification Number is: _____
(b) The ethnicity of the company's owner(s) is/are: _____
(c) Is the company a female owned business: _____ Yes _____ No

Date _____

_____ (Contractor)

By

_____ (Signature)

WARNING

U.S. Criminal Code, Section 1010, Title 18, U.S. C. Provides in part "Whoevermakes, passes, utters, or publishes any statement, knowing the same to be falseshall be fined not more than \$5,000 or imprisoned not more than two years or both."

EXHIBIT B: Certified Payroll Forms

CITY OF ALAMEDA PUBLIC WORKS DEPARTMENT SUBCONTRACTOR'S CERTIFICATION CONCERNING LABOR STANDARDS AND PREVAILING WAGE REQUIREMENTS		
(Appropriate Recipient):	DATE	
c/o	PROJECT NUMBER (if any)	
	PROJECT NAME	
1. The undersigned, having executed a contract with _____ _____ for _____ in the amount of \$_____ In the construction of the above-identified project, certifies that: (a) The Labor Standards provisions of the contract for construction are included in the aforesaid contract; (b) Neither he nor any firm, partnership or association in which he has substantial interest is designated as an ineligible contractor by the Comptroller General of the United States pursuant to Section 5.6(b) of the Regulations of the Secretary Labor, part 5 (29 CFR, Part 5) or pursuant to Section 3(a) of the Davis-Bacon Act as amended (40 U.S.C.. 276u-2(a)). (b) No part of the aforementioned contract has been or will be subcontracted to any subcontractor if such subcontractor or any firm, corporation, partnership or association in which such subcontractor has a substantial interest is designated an ineligible contractor pursuant to any of the aforementioned regulatory or statutory provisions.		
2. He agrees to obtain and forward to the aforementioned recipient within ten days after the execution of any subcontract, including those executed by his subcontractors and any lower tier subcontractors, a Subcontractor's Certification Concerning Labor Standards at Prevailing Wage Requirements executed by the subcontractors.		
(a) The workmen will report for duty on or about _____ (date).		
3. He certifies that: (a) The legal name and the business address of the undersigned are:		
(b) The undersigned is:		
(1) A SINGLE PROPRIETORSHIP		(3) A CORPORATION ORGANIZED IN THE STATE OF
(2) A PARTNERSHIP		(4) OTHER ORGANIZATION (Describe)
(c) The name, title and address of the owner, partners or officers of the undersigned are:		
NAME		ADDRESS

EXHIBIT B: Certified Payroll Forms

(d) The names and address of all other persons, both natural and corporate, having a substantial interest in the undersigned, and the nature of the interest are (if none, so state):		
NAME	TITLE	ADDRESS
(e) The names, address and trade classification of all other building construction contractors in which the undersigned, has a substantial interest are (if none, so state):		
NAME	TITLE	ADDRESS

3. He certifies:
(a) The company's Federal Tax Identification Number is: _____
(b) The ethnicity of the company's owner(s) is/are: _____
(c) Is the company a female owned business: _____ Yes _____ No

Date: _____

_____ (Contractor)

By _____ (Signature)

WARNING

U.S. Criminal Code, Section 1010, Title 18, U.S. C. Provides in part "Whoevermakes, passes, utters, or publishes any statement, knowing the same to be falseshall be fined not more than \$5,000 or imprisoned not more than two years or both."